

COMPRESSED AIR FILTER - LARGE



SF17 (G1, G1¼, G1½)

FEATURES

Shavo's Designer Series Large Flow Range general purpose Filter removes upto 99% of the liquid water.

Design of the filter elements gives both surface and depth filtration for cleaner air.

Ideally suited for header lines and large flow rated tools and cylinder operations.



PARAMETERS	SPECIFICATIONS
Pipe Threads	G 1, 1¼, 1½ Parallel (F) - Standard
Filter Element Size	5, 25, 40/50, * micron
Element Material	Plastic (Polypropylene) - Standard Sintered Bronze - Optional
Body Material	Al. Alloy die-cast
Bowl Material	Al. Alloy Metal with sight glass - Standard
Maximum Inlet Pressure	250 psig (17.5 bar)
Maximum Operating 80° C (175° F) Temperature (ambient)	
Standard Nominal Flow Rate At 6 bar (87 PSI) supply pressure and 14.5 PSI (1 bar) pressure drop	880 scfm (415 dm³/sec) C.V. (16.60)
Drain	Manual - Standard Automatic - Optional

+ Values indicated are with 50 micron elements, with finer elements these values will be lower.

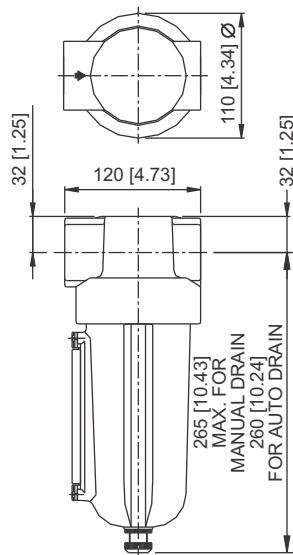

Technical know-how, design and drawings originally from C.A. Norgren Co. USA

COMPRESSED AIR FILTER - LARGE



SF17 (G1, G1¼, G1½)

Size	Flow (dm³/s)	Element (um)	Drain	Bowl	Model
G1	880 scfm (415 dm³/sec)	50	Auto Manual	Metal Metal	SF17-800-A3DC SF17-800-M3DC
G 1 ½	880 scfm (415 dm³/sec)	50	Auto Manual	Metal Metal	SF17-B00-A3DC SF17-B00-M3DC

Option Selector

Sample Model Number → **S F 1 7 8 0 0 M 3 D C**

Position → **0 1 2 3 4 5 6 7 8 9 10**

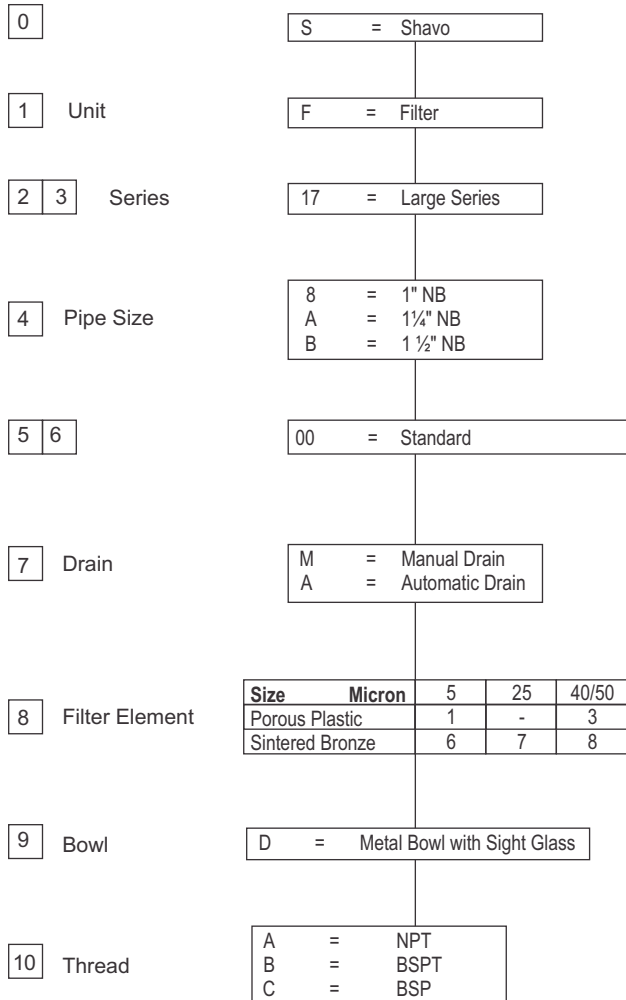

Technical know-how, design and drawings originally from C.A. Norgren Co. USA